

## General Description Of The Company

Anhui Forklift Group Corporation Ltd. (hereinafter referred as Heli) is a leading enterprise of industrial trucks in China.

Since 2016, Heli has been ranked among the top seven in the world, representing Chinese brands to forge ahead towards higher stage. (According to the "Top 20 Industrial lift truck suppliers" released by MMH.)

As the leading enterprise in China industrial truck industry, Heli has the ability and strength to participate in the global competition in a higher level, larger scale and wider field. Heli has established overseas centers in France, Thailand and the United States, which enhance the service ability in overseas market. Besides, relying on our global partners, we have established an overseas marketing and service network in more than 80 countries and regions, and Heli products are sold to more than 150 countries and regions in the world. In the next five years, Heli will vigorously promote the international operation and create a global famous brand.



## CPD15/16/ 18/20 SQ GE1LI/GE2LI



**ION** **3000-4000 lbs**  
G3 series Three-wheel Lithium Battery  
Forklift Truck (Double Drive)

\* Details of specifications and equipment are based on information available at time of printing and may change without notice.

### HELI AMERICA INC

ADD: 4025 Welcome All Road, Suite 150 Atlanta, GA30349, U.S.A.

E-MAIL: heli@heliforkliftamerica.com

TEL: 404-242-3288



HELI

COMPACT IN SIZE

BIG ON PERFORMANCE



POWERFUL LITHIUM-ION  
TECHNOLOGY



## Higher Performance, Quicker Working Efficiency

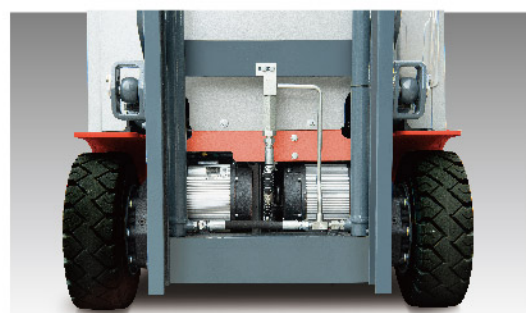

Front wheel dual drive motors provide more power.

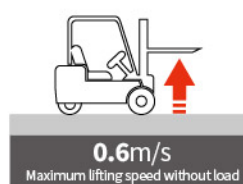
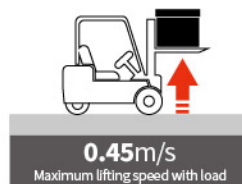

## Fast Charging For Long Battery Life



Be equipped with full hydraulic priority steering system, supply oil on demand, reduce vehicle energy consumption

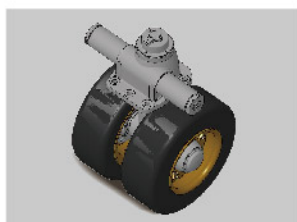

High precision angle potentiometer makes steering more sensitive and accurate.



LED light of the whole truck has high brightness, long life and is more energy saving.



Low rolling resistance electric truck special solid tire reduces driving resistance consumption.

## Small Dimension, More Flexible

- Narrow truck width is more suitable for narrow aisle application;
- Large angle steering axle makes the turning radius smaller satisfying the loading and unloading operation in narrow aisle.



## High Efficient Fast Charging, Ultra Long Endurance

- Realizes faster charging; standard 202ah lithium battery has ultra long endurance;
- The high density energy and fast charging characteristics of lithium battery make it possible to carry out full time operation without interruption.

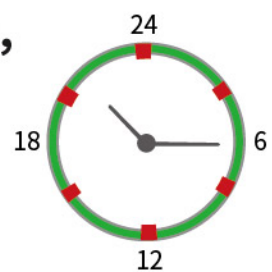

Working time Charging time



## Enjoyable Driving Experience



CURTIS Display



FJ Display

- P — Powerful
  - E — Economical
  - S — Energy-saving
- Multi-gear performance mode can adapt to a Variety of working conditions at will.

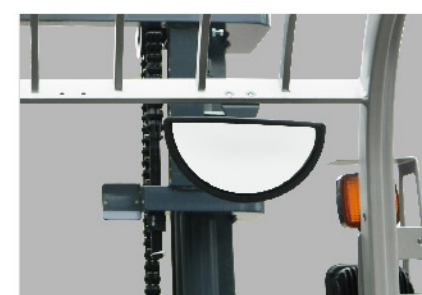

Middle rearview mirror



Parking system



USB power supply



Storage box



Wide view mast



Enough space



## Intelligent Security Protection

- **Intelligent stabilization system:** it can automatically adjust the tilt angle and speed of the mast according to the lifting height and load state. Improve the high bearing capacity and vehicle stacking safety;
- **Intelligent speed limit in different application:** multi-scenario identification and intelligent speed limit balance efficiency and safety;
- **Intelligent limit buffering:** intelligent induction of mast lifting and lowering avoids extreme impact and is safe and comfortable;
- **Intelligent operation protection:** a full set of OPS system can avoid misoperation and ensure safety;
- **Intelligent control strategy:** dual core controller is in line with the latest EU safety requirements.
- **Intelligent steering deceleration:** the automatic deceleration function of the turning can reduce the risk of turning over;
- **Lithium battery which heats itself automatically at low temperatures** has excellent low temperature adaptability.

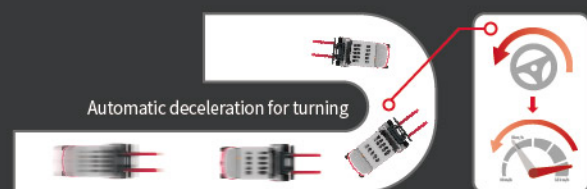
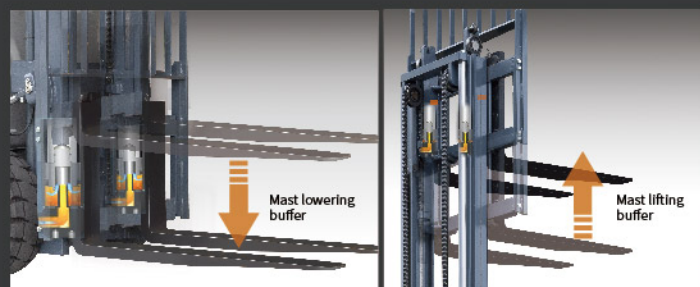
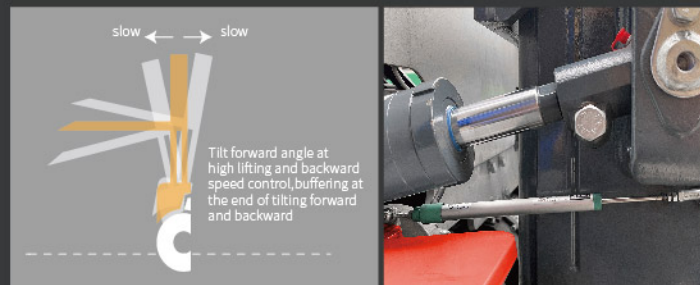

## Reliable, Superb Quality, Easy to Maintain

- This forklift can work in cold storage at minus 20 degrees Celsius. And the reinforced cast steering axle and the mast of optimized design ensure safety.

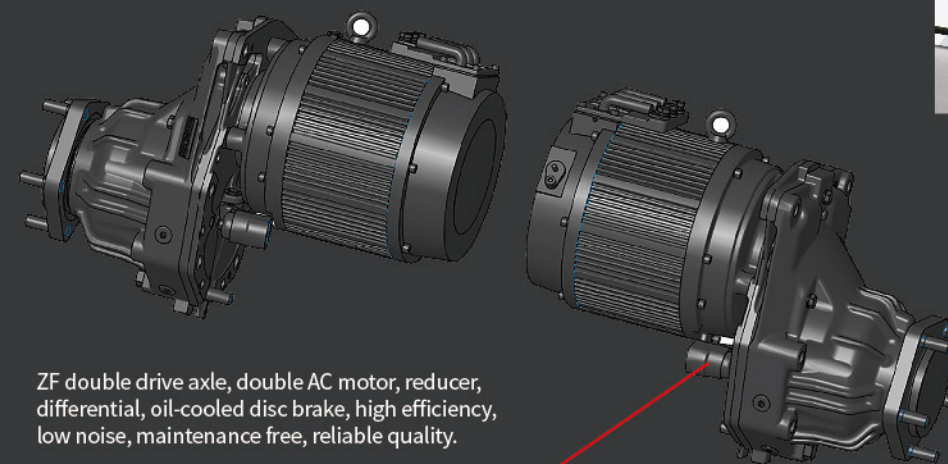

## Operating Cost Comparison:

### Lithium battery forklift vs. Lead-acid battery forklift vs. IC forklift

The advantages of HELI lithium battery forklift trucks are more prominent in the life cycle cost. Compared with internal combustion forklift truck, lithium battery forklift truck has the advantages of no noise, no pollution, small vibration and simple operation. Compared with the lead-acid battery forklift truck, lithium battery forklift has the characteristics of fast charging and charging at any time, which is more suitable for multi shift operation. Besides, HELI lithium battery forklift is maintenance free, high power conversion efficiency, and economical overall operation cost.

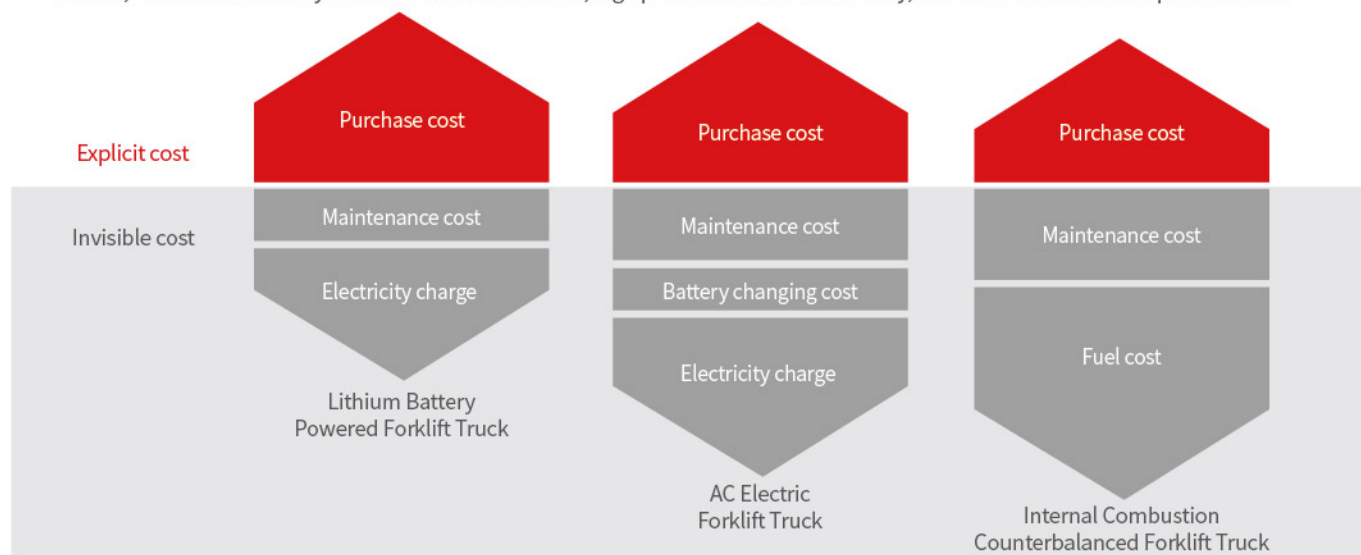

| HELI smart fleet management system (domestic basic edition) |                                       |
|---|---------------------------------------|
| Vehicle positioning   | Statistical form                      |
| Remote diagnosis  | Vehicle management                    |
| Remote monitoring   | Identification recognition (optional) |
| Maintenance reminder  | Weight management (optional)          |
| Battery management  | Collision management (optional)       |

HELI Intelligent Forklift Team Management



| Manufacturer and Technical Data |   |                     |             |             |             |
|---------------------------------|---|---------------------|-------------|-------------|-------------|
| Characteristics                 |   |                     |             |             |             |
| 1.01                            | Manufacturer                                | <b>HELI</b>         |             |             |             |
| 1.02                            | Model                                       | CPD15SQ             | CPD16SQ     | CPD18SQ     | CPD20SQ     |
| 1.03                            | Configuration number                        | GE1LI/GE2LI         | GE1LI/GE2LI | GE1LI/GE2LI | GE1LI/GE2LI |
| 1.04                            | Rated capacity                              | lbs 3000            | 3200        | 3500        | 4000        |
| 1.05                            | Load center distance                        | in 24               | 24          | 24          | 24          |
| 1.06                            | Power mode                                  | Lithium Battery     |             |             |             |
| 1.07                            | Driving mode                                | Seated              |             |             |             |
| 1.08                            | Load distance, center of drive axle to fork | in 14.4             | 14.4        | 14.4        | 14.6        |
| 1.09                            | Wheelbase                                   | in 50.9             | 50.9        | 55.1        | 55.1        |
| <b>Weight</b>                   |   |                     |             |             |             |
| 2.01                            | Total weight (with/without battery)         | lbs 6380/5764       | 6457/5841   | 7095/6480   | 7341/6724   |
| <b>Tyres</b>                    |   |                     |             |             |             |
| 3.01                            | Tyre type                                   | SE                  | SE          | SE          | SE          |
| 3.02                            | Tyre size, front                            | 18x7-8              | 18x7-8      | 200/50-10   | 200/50-10   |
| 3.03                            | Tyre size, rear                             | 140/55-9            | 140/55-9    | 16X6-8      | 16X6-8      |
| 3.04                            | Wheels, number front/rear (x=driven wheels) | 2x/2                | 2x/2        | 2x/2        | 2x/2        |
| 3.05                            | Tread, front                                | in 36.2             | 36.2        | 36.5        | 36.5        |
| 3.06                            | Tread, rear                                 | in 7.8              | 7.8         | 9.8         | 9.8         |
| <b>Dimensions</b>               |   |                     |             |             |             |
| 4.01                            | Height of overhead guard                    | in 80.3             | 80.3        | 80.3        | 80.3        |
| 4.02                            | Height of seat                              | in 41.2             | 41.2        | 41.9        | 41.9        |
| 4.03                            | Overall length (with/without fork)          | in 112.2/76         | 112.2/76    | 116.9/80.9  | 116.9/80.9  |
| 4.04                            | Overall width                               | in 41.7/42.4        | 41.7/42.4   | 41.7/44.1   | 41.7/44.1   |
| 4.05                            | Ground clearance (laden, between mast)      | in 3.5              | 3.5         | 3.5         | 3.5         |
| 4.06                            | Ground clearance (center of wheelbase)      | in 3.9              | 3.9         | 3.9         | 3.9         |
| 4.07                            | Min. outside turning radius                 | in 60.8             | 60.8        | 65.9        | 65.9        |
| <b>Performance Data</b>         |   |                     |             |             |             |
| 5.01                            | Travel speed (laden/unladen)                | mph 10/10.6         | 10/10.6     | 10/10       | 10/10       |
| 5.02                            | Lift speed (laden/unladen)                  | fpm 88.6/127.9      | 88.6/127.9  | 80.7/118.1  | 78.7/118.1  |
| 5.03                            | Lowering speed (laden/unladen)              | fpm 114.2/98.4      | 114.2/98.4  | 114.2/98.4  | 114.2/98.4  |
| 5.04                            | Max. gradeability (laden/unladen)           | % 22/30             | 22/30       | 22/30       | 22/30       |
| <b>Battery</b>                  |   |                     |             |             |             |
| 6.01                            | Battery voltage/Capacity                    | V/Ah 80/202         | 80/202      | 80/202      | 80/202      |
| <b>Motor and controller</b>     |   |                     |             |             |             |
| 7.01                            | Driving motor powering (S2-60min)           | HP 7.7x2            | 7.7x2       | 7.7x2       | 7.7x2       |
| 7.02                            | Lifting motor powering (S3-15%)             | HP 18.8             | 18.8        | 18.8        | 18.8        |
| 7.03                            | Driving motor controlling mode              | MOSFET/AC           |             |             |             |
| 7.04                            | Lifting motor controlling mode              | MOSFET/AC           |             |             |             |
| <b>Addition data</b>            |   |                     |             |             |             |
| 8.01                            | Service brake/Parking brake                 | Hydraulic/Hydraulic |             |             |             |

Note: For configuration number, 1: CURTIS Controller; 2: ZAPI Controller;

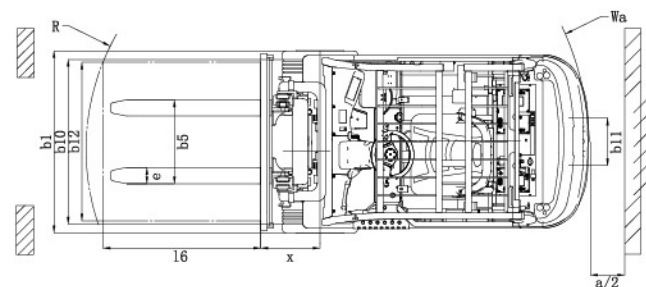
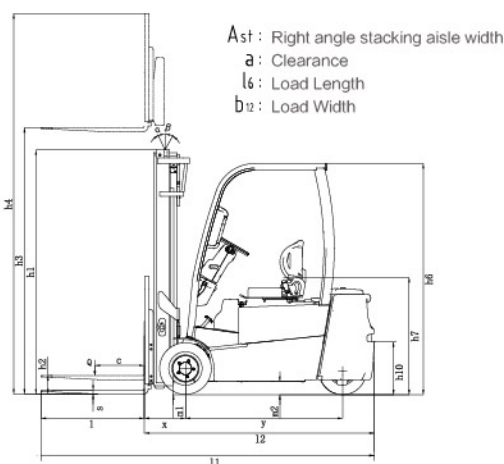

| WIDE VIEW MAST |                             |   |           |           |           |  |                      |         |         |         |                            |
|----------------|-----------------------------|---|-----------|-----------|-----------|--|----------------------|---------|---------|---------|----------------------------|
| Mast model     | Max. lifting height (in/mm) | Load capacity (load center 500mm)(lbs/kg) |           |           |           | Mast overall height (fork to the ground) (in/mm) | Service weight (lbs) |         |         |         | Mast tilting angle (°) α/β |
|                |                             | CPD15SQ                                   | CPD16SQ   | CPD18SQ   | CPD20SQ   |  | CPD15SQ              | CPD16SQ | CPD18SQ | CPD20SQ |                            |
| M200           | 79/2000                     | 3000/1362                                 | 3200/1454 | 3500/1589 | 4000/1816 | 60/1525  | 6222                 | 6299    | 6917    | 7149    | 5/7                        |
| M250           | 98/2500                     | 3000/1362                                 | 3200/1454 | 3500/1589 | 4000/1816 | 69.9/1775  | 6281                 | 6358    | 6998    | 7229    | 5/7                        |
| M300           | 118/3000                    | 3000/1362                                 | 3200/1454 | 3500/1589 | 4000/1816 | 79.7/2025  | 6345                 | 6400    | 7060    | 7291    | 5/7                        |
| M330           | 130/3300                    | 3000/1362                                 | 3200/1454 | 3500/1589 | 4000/1816 | 85.6/2175  | 6380                 | 6457    | 7095    | 7341    | 5/7                        |
| M350           | 138/3500                    | 3000/1362                                 | 3200/1454 | 3500/1589 | 4000/1816 | 89.6/2275  | 6402                 | 6470    | 7119    | 7350    | 5/7                        |
| M370           | 146/3700                    | 3000/1362                                 | 3200/1454 | 3500/1589 | 4000/1816 | 93.5/2375  | 6428                 | 6483    | 7143    | 7374    | 5/7                        |
| M400           | 157/4000                    | 3000/1362                                 | 3200/1454 | 3500/1589 | 4000/1816 | 101.4/2575                                       | 6523                 | 6578    | 7238    | 7469    | 3/5                        |
| M425           | 167/4250                    | 3000/1362                                 | 3200/1454 | 3500/1589 | 3630/1650 | 106.3/2700                                       | 6615                 | 6673    | 7333    | 7564    | 3/5                        |
| M450           | 177/4500                    | 2750/1250                                 | 2860/1300 | 3300/1500 | 3630/1650 | 111.2/2825                                       | 6651                 | 6706    | 7366    | 7597    | 3/5                        |
| M500           | 197/5000                    | 2530/1150                                 | 2750/1250 | 3080/1400 | 3300/1500 | 121.1/3075                                       | 6719                 | 6774    | 7434    | 7665    | 3/5                        |
| M550           | 217/5500                    | 2090/950                                  | 2310/1050 | 2750/1250 | 2750/1250 | 132.9/3375                                       | 6846                 | 6901    | 7531    | 7792    | 3/3                        |
| M600           | 236/6000                    | 1540/700                                  | 1760/800  | 1870/850  | 2090/950  | 142.7/3625                                       | 6915                 | 6970    | 7630    | 7861    | 3/3                        |

| WIDE VIEW FULL FREE 2-STAGE MAST |                             |   |           |           |           |  |   |                      |         |         |         |                            |
|----------------------------------|-----------------------------|---|-----------|-----------|-----------|--|---|----------------------|---------|---------|---------|----------------------------|
| Mast model                       | Max. lifting height (in/mm) | Load capacity (load center 500mm)(lbs/kg) |           |           |           | Mast overall height (fork to the ground) (in/mm) | Free lifting height (with backrest) (in/mm) | Service weight (lbs) |         |         |         | Mast tilting angle (°) α/β |
|                                  |                             | CPD15SQ                                   | CPD16SQ   | CPD18SQ   | CPD20SQ   |  |   | CPD15SQ              | CPD16SQ | CPD18SQ | CPD20SQ |                            |
| ZM200                            | 79/2000                     | 3000/1362                                 | 3200/1454 | 3500/1589 | 4000/1816 | 60/1525  | 20.1/510                                    | 6281                 | 6358    | 7000    | 7117    | 5/7                        |
| ZM250                            | 98/2500                     | 3000/1362                                 | 3200/1455 | 3500/1589 | 4000/1816 | 69.9/1775  | 29.9/760                                    | 6345                 | 6422    | 7060    | 7181    | 5/7                        |
| ZM300                            | 118/3000                    | 3000/1362                                 | 3200/1456 | 3500/1589 | 4000/1816 | 79.7/2025  | 39.8/1010                                   | 6406                 | 6461    | 7121    | 7242    | 5/7                        |
| ZM330                            | 130/3300                    | 3000/1362                                 | 3200/1457 | 3500/1589 | 4000/1816 | 85.6/2175  | 45.7/1160                                   | 6446                 | 6523    | 7161    | 7260    | 5/7                        |
| ZM350                            | 138/3500                    | 3000/1362                                 | 3200/1458 | 3500/1589 | 4000/1816 | 89.6/2275  | 49.6/1260                                   | 6470                 | 6540    | 7185    | 7306    | 5/7                        |
| ZM370                            | 146/3700                    | 3000/1362                                 | 3200/1459 | 3500/1589 | 4000/1816 | 93.5/2375  | 53.5/1360                                   | 6501                 | 6556    | 7216    | 7381    | 5/7                        |
| ZM400                            | 157/4000                    | 3000/1362                                 | 3200/1460 | 3500/1589 | 4000/1816 | 101.4/2575                                       | 61.4/1560                                   | 6600                 | 6655    | 7315    | 7436    | 3/5                        |

| WIDE VIEW FULL FREE 3-STAGE MAST |                             |   |           |           |           |  |   |                      |         |         |         |                            |
|----------------------------------|-----------------------------|---|-----------|-----------|-----------|--|---|----------------------|---------|---------|---------|----------------------------|
| Mast model                       | Max. lifting height (in/mm) | Load capacity (load center 500mm)(lbs/kg) |           |           |           | Mast overall height (fork to the ground) (in/mm) | Free lifting height (with backrest) (in/mm) | Service weight (lbs) |         |         |         | Mast tilting angle (°) α/β |
|                                  |                             | CPD15SQ                                   | CPD16SQ   | CPD18SQ   | CPD20SQ   |  |   | CPD15SQ              | CPD16SQ | CPD18SQ | CPD20SQ |                            |
| ZSM360                           | 142/3600                    | 3000/1362                                 | 3200/1460 | 3500/1589 | 4000/1816 | 70.5/1790  | 30.7/781                                    | 6697                 | 6774    | 7412    | 7753    | 3/5                        |
| ZSM400                           | 157/4000                    | 3000/1363                                 | 3200/1460 | 3500/1589 | 4000/1816 | 75.8/1925  | 36.1/916                                    | 6752                 | 6829    | 7467    | 7808    | 3/5                        |
| ZSM435                           | 171/4350                    | 3000/1364                                 | 2860/1300 | 3300/1500 | 3630/1650 | 80.3/2040  | 40.6/1031                                   | 6813                 | 6890    | 7528    | 7869    | 3/5                        |
| ZSM450                           | 177/4500                    | 2750/1250                                 | 2860/1300 | 3300/1500 | 3630/1650 | 82.3/2090  | 42.6/1081                                   | 6838                 | 6915    | 7553    | 7894    | 3/5                        |
| ZSM470                           | 185/4700                    | 2640/1200                                 | 2750/1250 | 3190/1450 | 3410/1550 | 85/2160  | 45.3/1151                                   | 6873                 | 6950    | 7581    | 7922    | 3/5                        |
| ZSM480                           | 189/4800                    | 2640/1200                                 | 2750/1250 | 3190/1450 | 3410/1550 | 86.2/2190  | 46.5/1181                                   | 6884                 | 6961    | 7592    | 7933    | 3/5                        |
| ZSM500                           | 197/5000                    | 2310/1050                                 | 2530/1150 | 3080/1400 | 3300/1500 | 90.1/2290  | 50.4/1281                                   | 6932                 | 7009    | 7641    | 7982    | 3/5                        |
| ZSM540                           | 213/5400                    | 1980/900                                  | 2200/1000 | 2420/1100 | 2750/1250 | 95.5/2425  | 55.7/1416                                   | 7055                 | 7132    | 7764    | 8105    | 3/3                        |
| ZSM600                           | 236/6000                    | 1540/700                                  | 1760/800  | 1870/850  | 2090/950  | 103.9/2640                                       | 64.2/1631                                   | 7143                 | 7220    | 7852    | 8193    | 3/3                        |
| ZSM650                           | 256/6500                    | 1320/600                                  | 1540/700  | 1760/800  | 1870/850  | 111.4/2830                                       | 71.7/1821                                   | 7236                 | 7313    | 7944    | 8285    | 3/3                        |

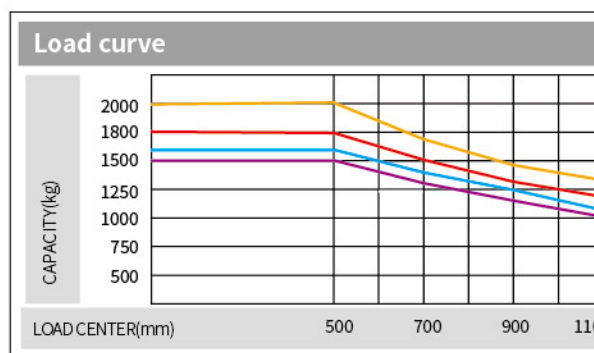

CPD15SQ CPD16SQ CPD18SQ CPD20SQ

**Note:** The vertical axis stands for load capacity and the horizontal axis stands for load center which is calculated from the front surface of the forks to the gravity of the standard load. The standard load means a cubic with 1000mm edge length. When mast is tilted forward, using non-standard forks or loading large goods, the load capacity will be reduced. The load capacity of standard mast at different load center can be known from this load chart.

| Optional   |   |   |   |
|--|---|---|---|
| Security class   | Steering automatic deceleration   |   | ● |
|  | Reversing handle with horn button   |   | ● |
|  | OPS system(Excluding descent)   |   | ● |
|  | Complete OPS system   |   | ○ |
|  | Seat belt switch  |   | ● |
|  | Multi way valve overload  |   | ● |
|  | Fire extinguisher   |   | ○ |
|  | Backward buzzer   |   | ● |
|  | Reversing Chinese language horn   |   | ○ |
|  | Electronic upper buffer   |   | ● |
|  | Rearview mirror with angle in the middle  |   | ● |
|  | Left and right rear mirror  |   | ○ |
|  | Tilt speed limit  |   | ● |
|  | Active stabilization<br>(Standard configuration for full free 3-stage mast above 4m ) |   | ● |
| Comfort class  | Standard seat   |   | ● |
|  | Fully suspended seat  |   | ○ |
|  | USB power   |   | ● |
|  | Mechanical valve  |   | ● |
|  | Solenoid valve (proportional valve + thumb switch)                                    |   | ○ |
|  | Fan   |   | ○ |
|  | Color screen instrument   |   | ● |
|  | Heater  |   | ○ |
|  | Performance mode control  |   | ● |
|  | Steering wheel with operation ball  |   | ● |
|  | Steering wheel without operation ball   |   | ○ |
|  | The height of overhead guard is increased by 50mm                                     |   | ○ |
|  | Overhead guard with protective net  |   | ○ |
|  | Non standard overhead guard   | Cab                                     |   |
| Cab/windshield glass   |   | Fit the front windshield                | ○ |
|  |   | Equipped with rear windshield           | ○ |
|  |   | Equipped with top rain glass            | ○ |
|  | Light class   | No rear work lights or rear blue lights |   |
| LED rear work light  |   |   | ○ |
| LED rear blue light (without switch control)                         |   |   | ○ |
| led rear work light and led rear blue light (without switch control) |   |   | ○ |
| LED flickering warning light   |   |   | ● |
| LED rotary warning light   |   |   | ○ |
| Led rotary buzzer warning light                                      |   |   | ○ |
| Other  |   | HEDING lithium battery                  |   |
|  | ENEROC lithium battery  |   | ○ |
|  | EIKTO lithium battery   |   | ○ |
|  | Solid tire  |   | ● |
|  | Traceless tyre  |   | ○ |
|  | Single tire (front wheel)   |   | ● |
|  | Double tire (front wheel)   |   | - |
|  | Metric thread   |   | ● |
|  | American thread   |   | ○ |
|  | Sleeve for Tilting cylinder   |   | ○ |
|  | Tilting cylinder,sleeve for steering cylinder   |   | ○ |
|  | HELI package  |   | ● |
|  | Neutral package   |   | ○ |
|  | Chinese sticker   |   | ● |
|  | English sticker   |   | ○ |
|  | Custom-made sticker   |   | ○ |
| HELI smart fleet management system(standard version)                 |   | ○                                       |   |

Note: ● standard ○ optional — non-configurable

| LITHIUM BATTERY CHARGER                    |                               |         |         |         |         |
|--|-------------------------------|---------|---------|---------|---------|
| Lithium battery brand                      | HELI                          |         | CATL    |         | EIKTO   |
|  | 80V/202                       | 80V/271 | 80V/202 | 80V/271 | 80V/271 |
| Voltage/Capacity                           | ●                             | ○       | ○       | ○       | ○       |
| CPD15/16/18/20SQ                           | ●                             | ○       | ○       | ○       | ○       |
| Low temperature heating of lithium battery |                               |         | ●       |         |         |
| Charger                                    | D80V200ALi-123 D80V200ALi-423 |         |         |         |         |

Note: ● standard ○ optional — non-configurable